

Layout
Scale 1:500

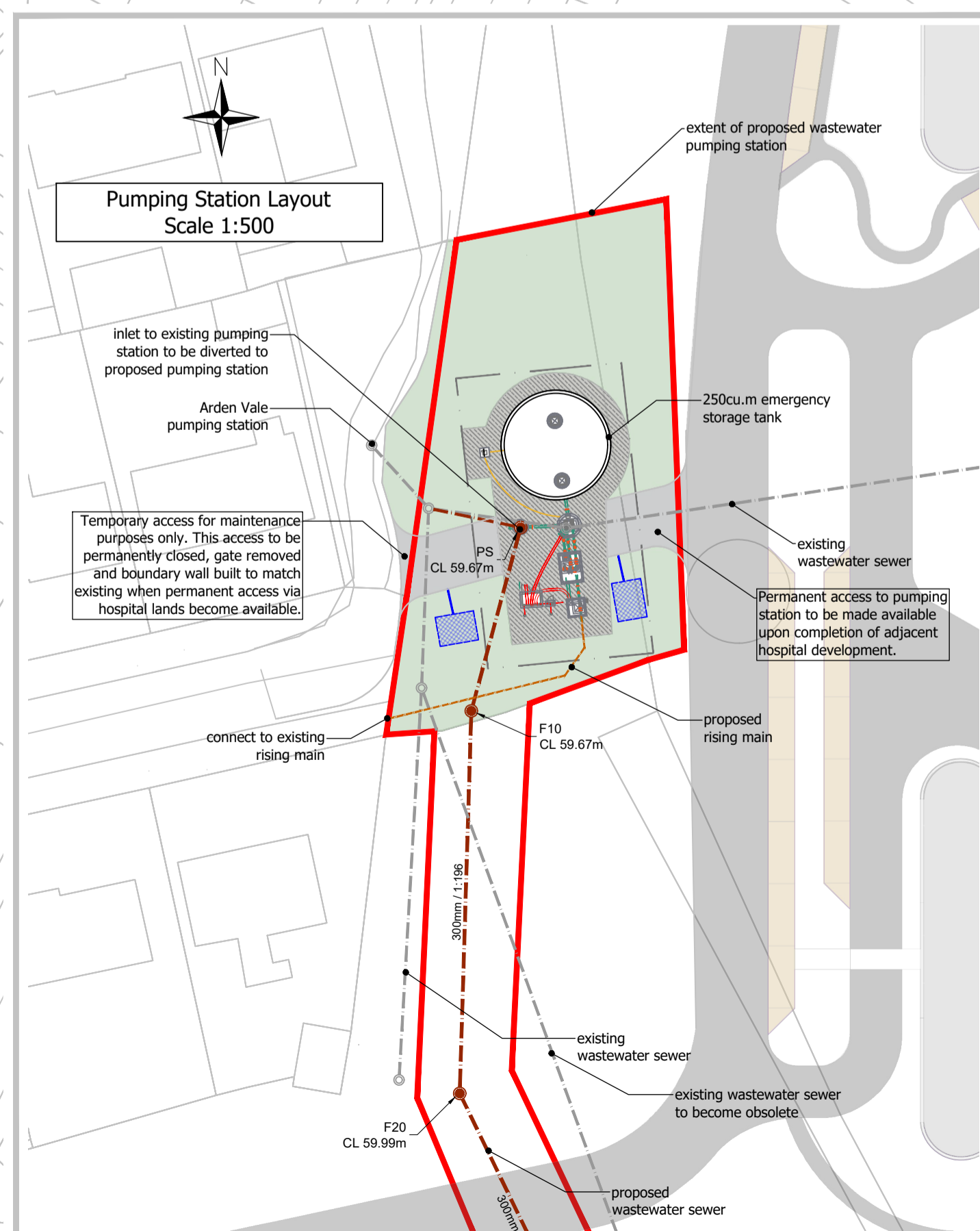

- GENERAL**
- Datum for levels is OS Malin Head.
 - Verify existing levels prior to commencement of works. Report any discrepancies immediately to the Employer's Representative.
 - The locations shown for existing services are indicative only and may not be accurate. Furthermore, uncharted services may also be present. The Contractor should assume the existence of services unless proven otherwise.
 - It is the Contractor's responsibility to determine the existence and precise location of any service located within the site. All works shall be carried out in strict accordance with the document 'Code of Practice for Avoiding Danger from Underground Services' as published by the Health and Safety Authority.

- WASTEWATER**
- Construction of wastewater infrastructure to comply with the Irish Water Code of Practice for Wastewater Infrastructure.
 - Pipes for wastewater gravity sewers shall be uPVC pipes application area code "UD", stiffness class 8kN/m² in accordance with 3.13 of the Irish Water 'Wastewater Code of Practice'.
 - Wastewater drains and sewers to be constructed in accordance with Detail W1.
 - The minimum separation between wastewater pipes and other services shall not be less than either that shown in STD-WW-05 or that shown on M&E drawings.
 - Each house to be served by a separate drain of min diameter 100mm dia. and laid to a minimum grade of 1 in 60.
 - Chambers on wastewater drains and sewers in public areas shall be in accordance with STD-WW-10.
 - Private-side inspection chambers shall be in accordance with STD-WW-02, STD-WW-03 and STD-WW-13 and shall have a minimum depth to invert of 0.5m and a maximum depth to invert of 1.2m.
 - Maximum depth to invert for Access Junctions to be 0.6m.
 - Proposed wastewater sewers to be uPVC SN8.

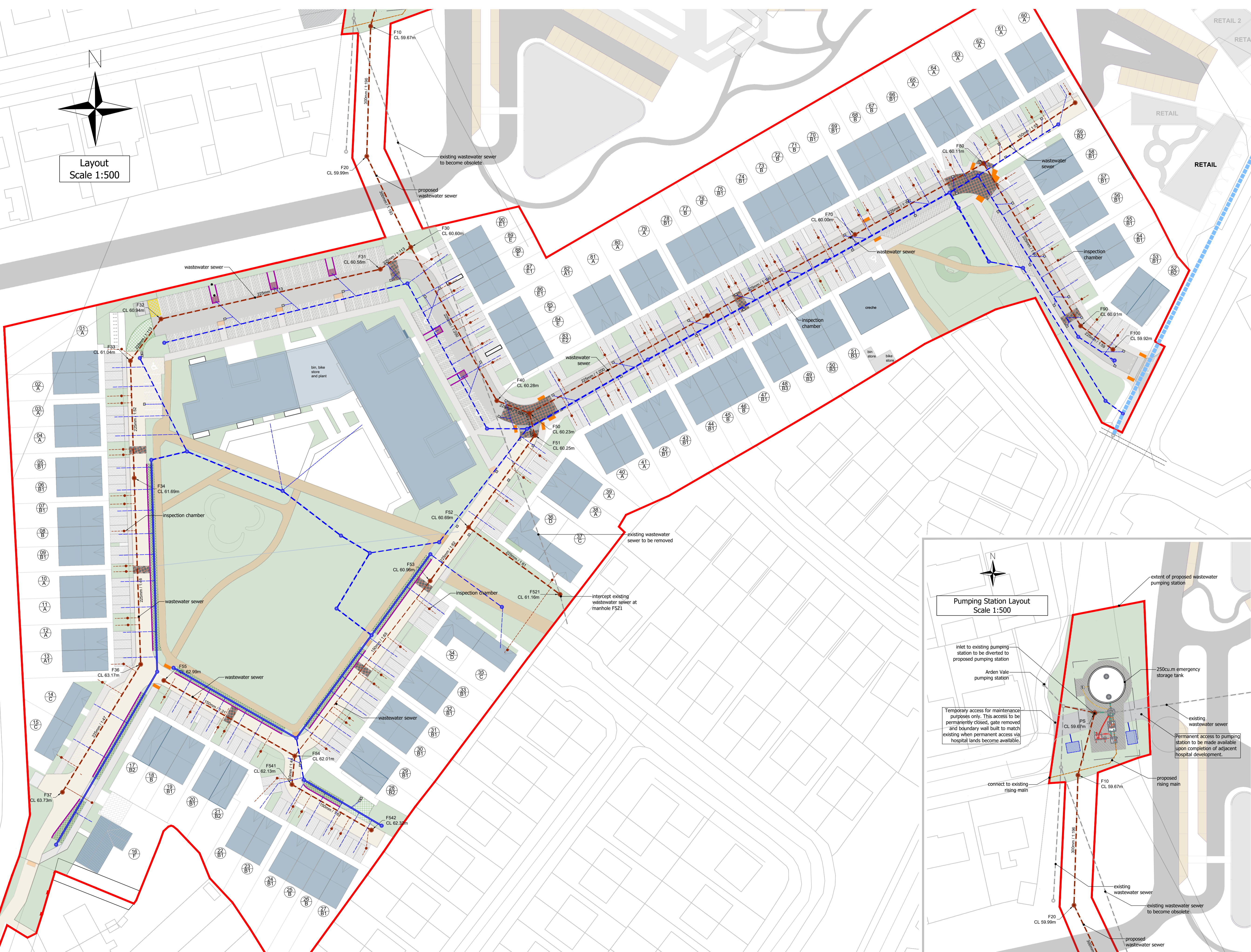
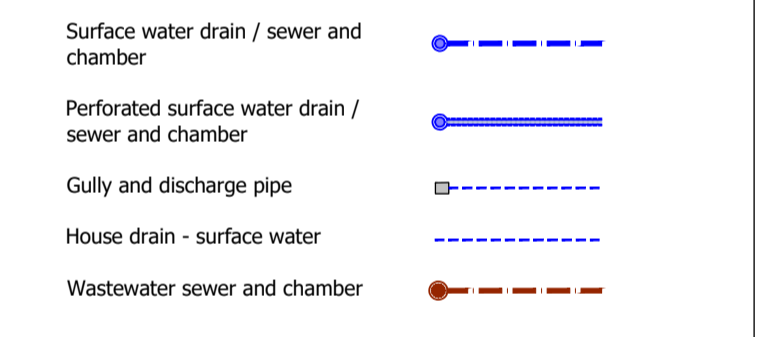

OS mapping reproduced under licence.
This drawing is not to be reproduced without the written permission of Kilgallen and Partners. Copyright.

REV	DATE	BY	DETAILS
PL6	15/05/23	SC	Notes added to access arrangements at pumping station
PL5	05/04/23	SC	Issued for LRD application
PL4	26/01/23	SC	Issued to OCC Water Services for comment
PL3	21/12/22	SC	Issued for Irish Water design approval FI
PL2	01/12/22	SC	Issued for Irish Water design approval
PR1	03/05/22	AB	Issued for discussion

STATUS
FOR PLANNING APPLICATION PURPOSES ONLY. NOT TO BE USED FOR ANY OTHER PURPOSE.

CLIENT
JOHN FLANAGAN DEVELOPMENTS

PROJECT
PUTTAGHAN LANDS, TULLAMORE

TITLE
WASTEWATER DRAINAGE - GENERAL LAYOUT

KILGALLEN & PARTNERS
CONSULTING ENGINEERS
E-mail: Info@kilgallen.ie, Web: www.kilgallen.ie

KYLEKIPROE
WELL ROAD
PORTLAOISE
T +353 56 866 2860

UNIT 3
DANVILLE BUSINESS PARK
KILKENNY
+353 56 777 01090

DRN:	DRAWING NO.:	REV.:	
SC	22009-C-DR-202	PL6	
CHKD:	SCALE:	SIZE:	DATE:
PB	1:500 @ A1	A1	03/05/2022